

SURVEY DISCLAIMER
TOPOGRAPHIC SURVEY ISSUE DATE: SEPTEMBER 25, 2015.
PROVIDED BY SURVEYOR'S ESP ASSOCIATES, P.A., P.O. BOX 730, 3475 LAKE MOUNT BLVD, CHARLOTTE, NC, 28241, 704.583.4949

SYMBOL	DETAIL
	PROPOSED SIDEWALK 10/C-801
	PROPOSED STANDARD ACCESSIBLE RAMP 17/C-801
	PROPOSED DIRECTIONAL ACCESSIBLE RAMP 19/C-801
	PROPOSED DOUBLE DIRECTIONAL ACCESSIBLE RAMP 19/C-801
	HEAVY DUTY CONCRETE 2/C-801
	PROPOSED STREET SIGN 3,4/C-802
	PROPOSED STOP SIGN R1-1
	PROPOSED 1' CONCRETE RIBBON CURB 20/C-805
	PROPOSED 2'-0" CURB & GUTTER 9/C-801
	PROPOSED LITTER RECEPTACLE 18/C-1400
	PROPOSED STREET LIGHT -/-

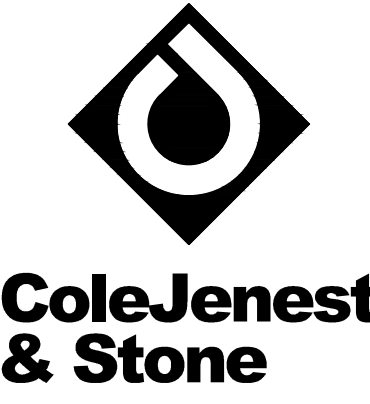

Shaping the Environment
Realizing the Possibilities

Land Planning
+
Landscape Architecture
Civil Engineering
+
Urban Design

200 South Tryon Street, Suite 1400
Charlotte, North Carolina 28202
p+ 704.376.1555 f+ 704.376.7851
url+ www.colejeneststone.com

Lennar Carolinas, LLC

**11230 CARMEL COMMONS BLVD
CHARLOTTE, NC 28226**

WestBranch Amenity

**ROBERT WALKER DRIVE
DAVIDSON, NC 28036**

OVERALL SITE PLAN

**Project No.
4418**

**Issued
01/17/18**

Revised



C-1000

The drawings, the project manual and the design shown thereon are instruments of ColeJenest & Stone, P.A. The reproduction or unauthorized use of the documents without consent of ColeJenest & Stone, P.A. is prohibited.

ColeJenest & Stone, P.A. 2016 ©

- North 811**
www.nc811.org
- CONTRACTOR IS FULLY RESPONSIBLE FOR CONTACTING APPROPRIATE PARTIES AND ASSURING THAT EXISTING UTILITIES ARE LOCATED PRIOR TO CONSTRUCTION.
 - CONTRACTOR IS RESPONSIBLE FOR PLACING BARRICADES USING FLAG MEN, ETC. AS NECESSARY TO INSURE SAFETY TO THE PUBLIC.
 - ALL PAVEMENT CUTS, CONCRETE OR ASPHALT, ARE TO BE REPLACED ACCORDING TO STANDARDS OF THE NORTH CAROLINA DEPARTMENT OF TRANSPORTATION AND CHARLOTTE-MECKLENBURG UTILITIES SPECIFICATIONS.
 - SHORING WILL BE ACCORDING TO OSHA TRENCHING STANDARDS PART 1926 SUBPART P, OR AS AMENDED.

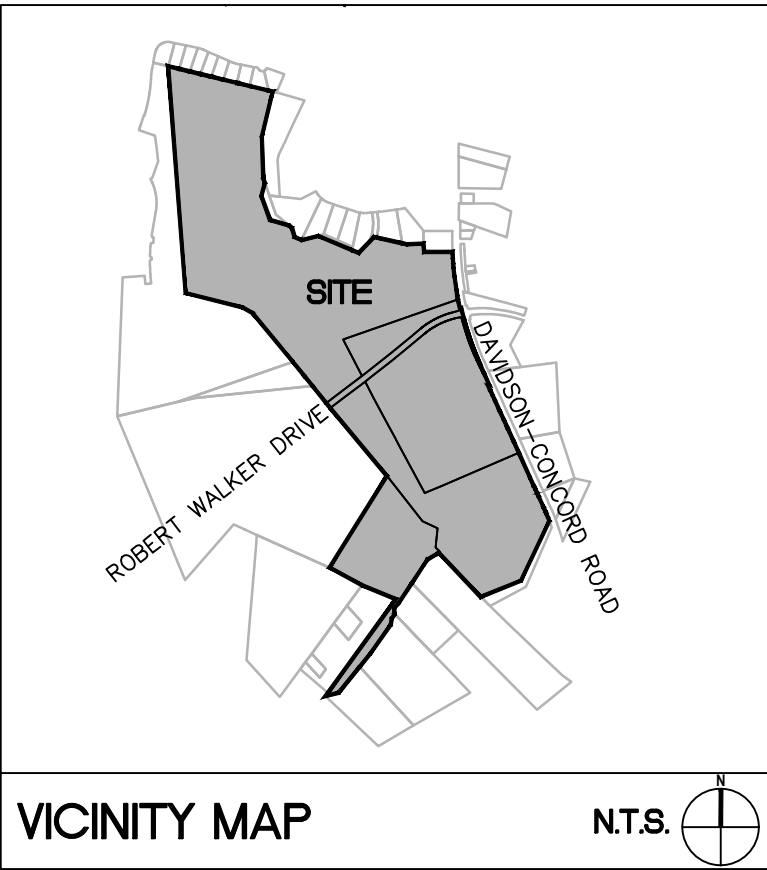
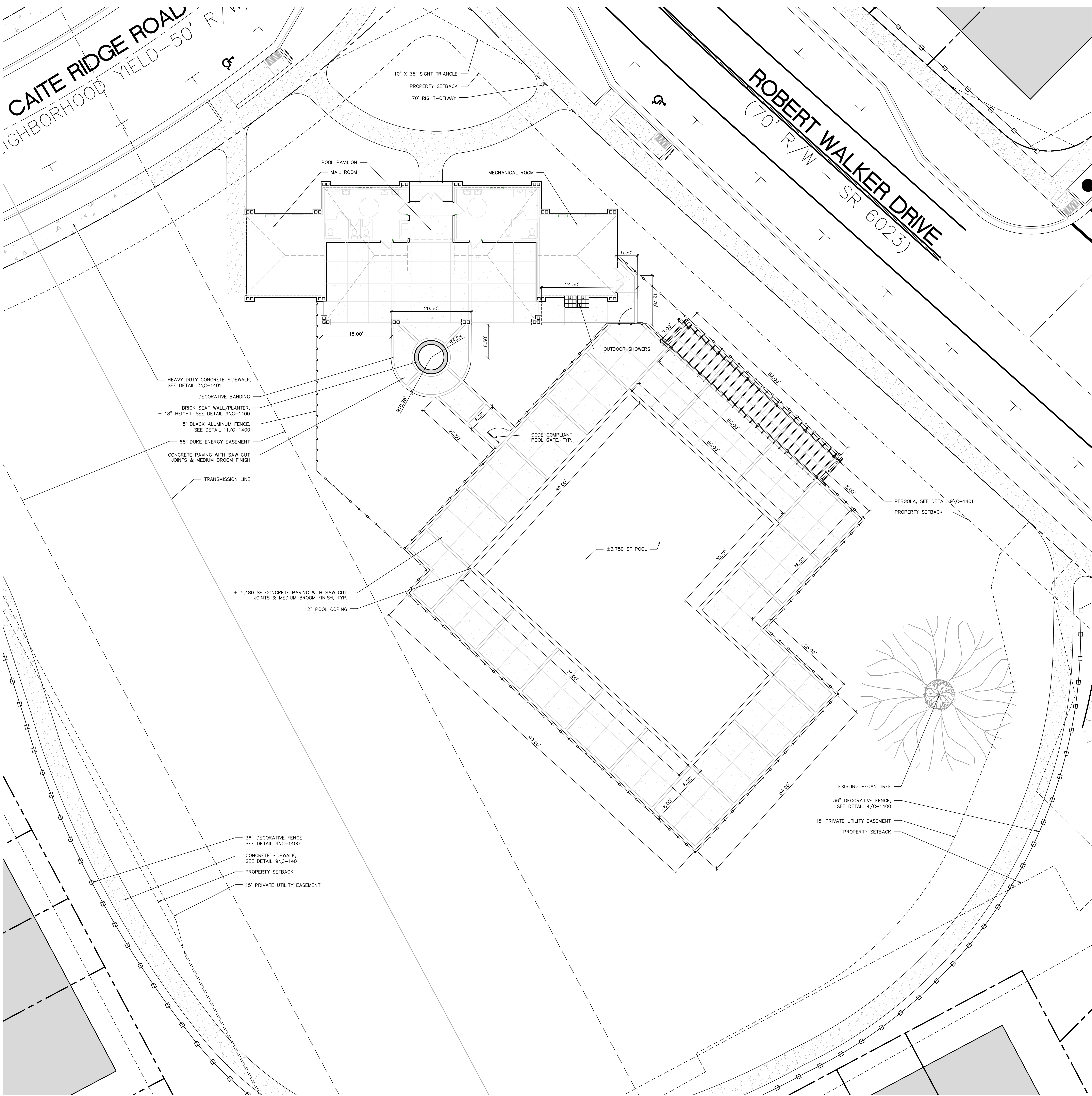

SURVEY DISCLAIMER
TOPOGRAPHIC SURVEY ISSUE DATE: SEPTEMBER 25, 2015.
PROVIDED BY SURVEYOR'S ESP ASSOCIATES, P.A., P.O. BOX 730, 3475 LAKEMOUNT BLVD, CHARLOTTE, NC, 28241, 704.583.4949

LEGEND	
SYMBOL	DETAIL
	PROPOSED SIDEWALK 10/C-801
	PROPOSED STANDARD ACCESSIBLE RAMP 17/C-801
	PROPOSED DIRECTIONAL ACCESSIBLE RAMP 19/C-801
	PROPOSED DOUBLE DIRECTIONAL ACCESSIBLE RAMP 19/C-801
	HEAVY DUTY CONCRETE 2/C-801
	PROPOSED STREET SIGN 3,4/C-802
	PROPOSED STOP SIGN R1-1
	PROPOSED 1' CONCRETE RIBBON CURB 20/C-805
	PROPOSED 2'-0" CURB & GUTTER 9/C-801
	PROPOSED LITTER RECEPTACLE 18/C-1400
	PROPOSED STREET LIGHT -/-

NOTE:
ALL DIMENSIONS ARE APPROXIMATE
AND SUBJECT TO VARIATION
THROUGHOUT THIS DECISION
PROCESS

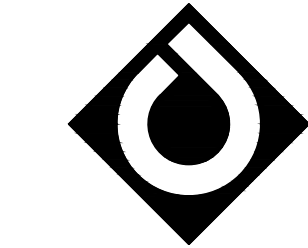

**ColeJenest
& Stone**

Shaping the Environment
Realizing the Possibilities

Land Planning
+ Landscape Architecture
Civil Engineering
+ Urban Design

200 South Tryon Street, Suite 1400
Charlotte, North Carolina 28202
p+ 704.376.1555 f+ 704.376.7851
url+ www.colejeneststone.com

Lennar Carolinas, LLC

**11230 CARMEL COMMONS BLVD
CHARLOTTE, NC 28226**

WestBranch Amenity

**ROBERT WALKER DRIVE
DAVIDSON, NC 28036**

DIMENSION CONTROL PLAN - POOL AMENITY ENLARGEMENT

Project No.

4418

Issued

01/17/18

Revised



SCALE: 1"= 10'
0 5' 10' 20'

C-1102

The drawings, the project manual and the design shown thereon are instruments of ColeJenest & Stone, P.A. The reproduction or unauthorized use of the documents without consent of ColeJenest & Stone, P.A. is prohibited.

ColeJenest & Stone, P.A. 2016 ©



- CONTRACTOR IS FULLY RESPONSIBLE FOR CONTACTING APPROPRIATE PARTIES AND ASSURING THAT EXISTING UTILITIES ARE LOCATED PRIOR TO CONSTRUCTION.
- CONTRACTOR IS RESPONSIBLE FOR PLACING BARRICADES USING FLAG MEN, ETC. AS NECESSARY TO INSURE SAFETY TO THE PUBLIC.
- ALL PAVEMENT CUTS, CONCRETE OR ASPHALT, ARE TO BE REPLACED ACCORDING TO STANDARDS OF THE NORTH CAROLINA DEPARTMENT OF TRANSPORTATION AND CHARLOTTE-MECKLENBURG UTILITIES SPECIFICATIONS.
- SHORING WILL BE ACCORDING TO OSHA TRENCHING STANDARDS PART 1926 SUBPART P, OR AS AMENDED.

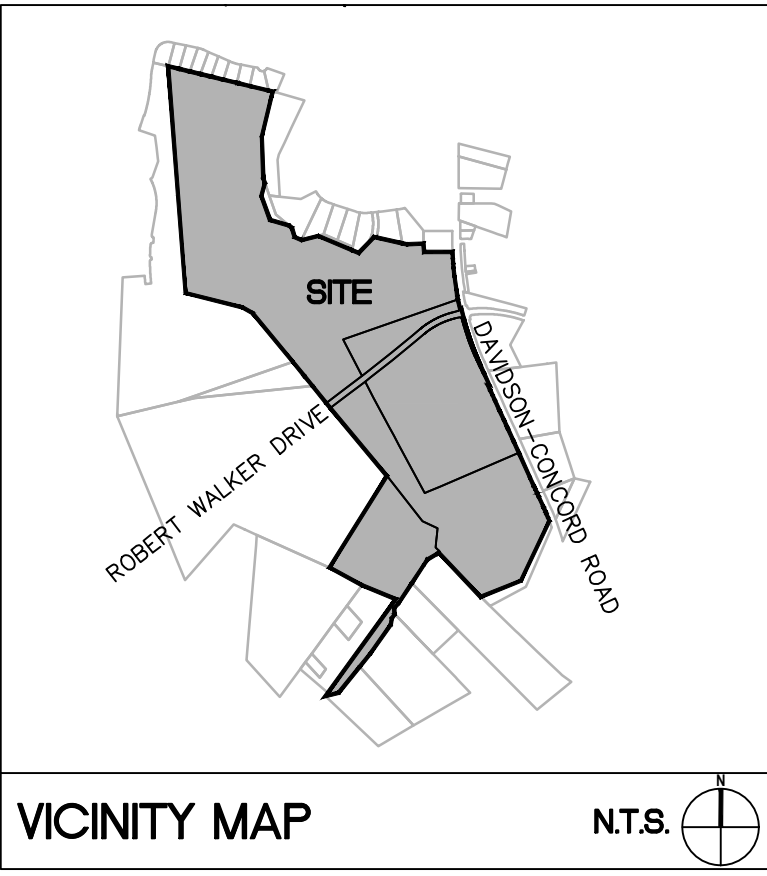
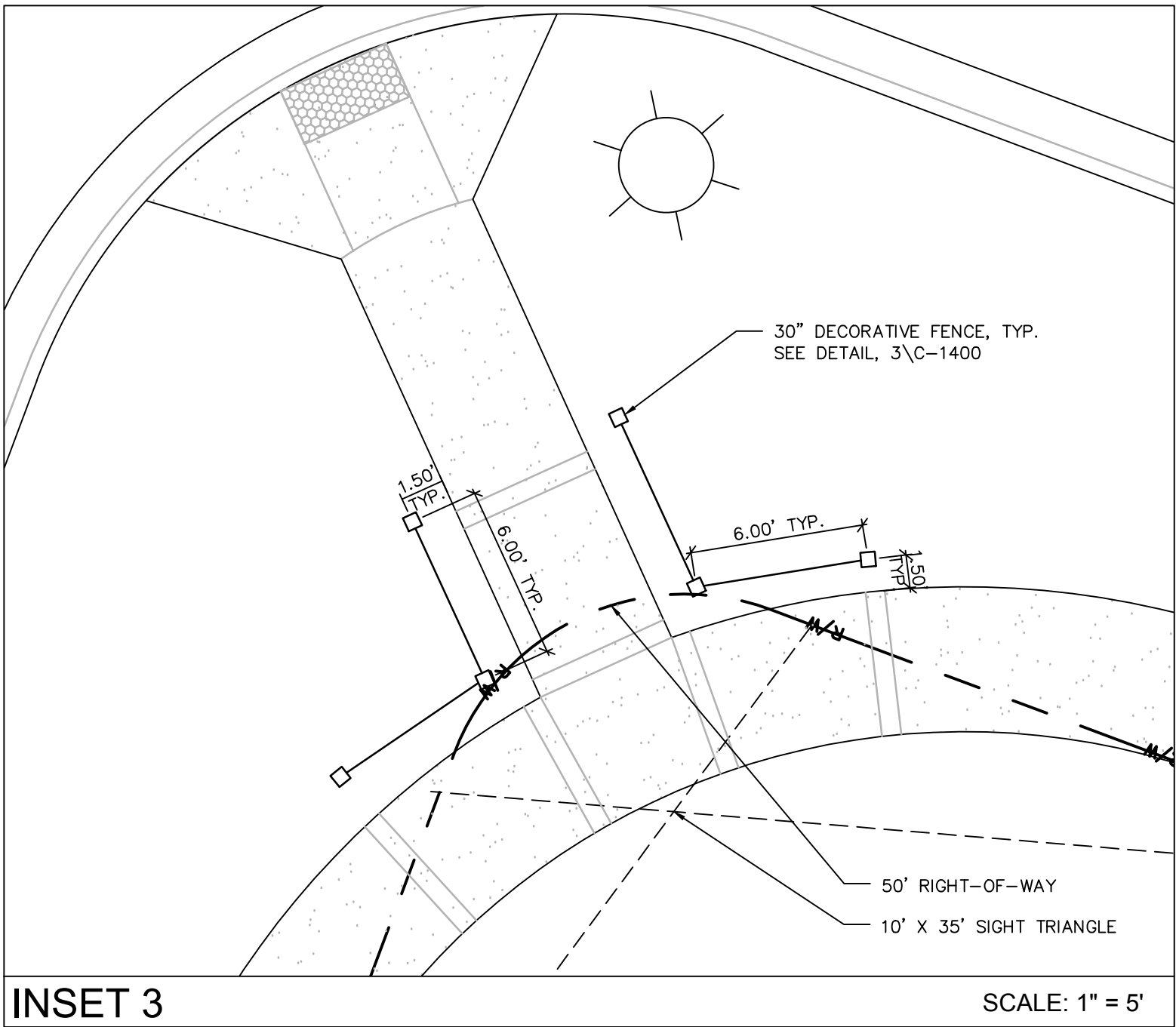
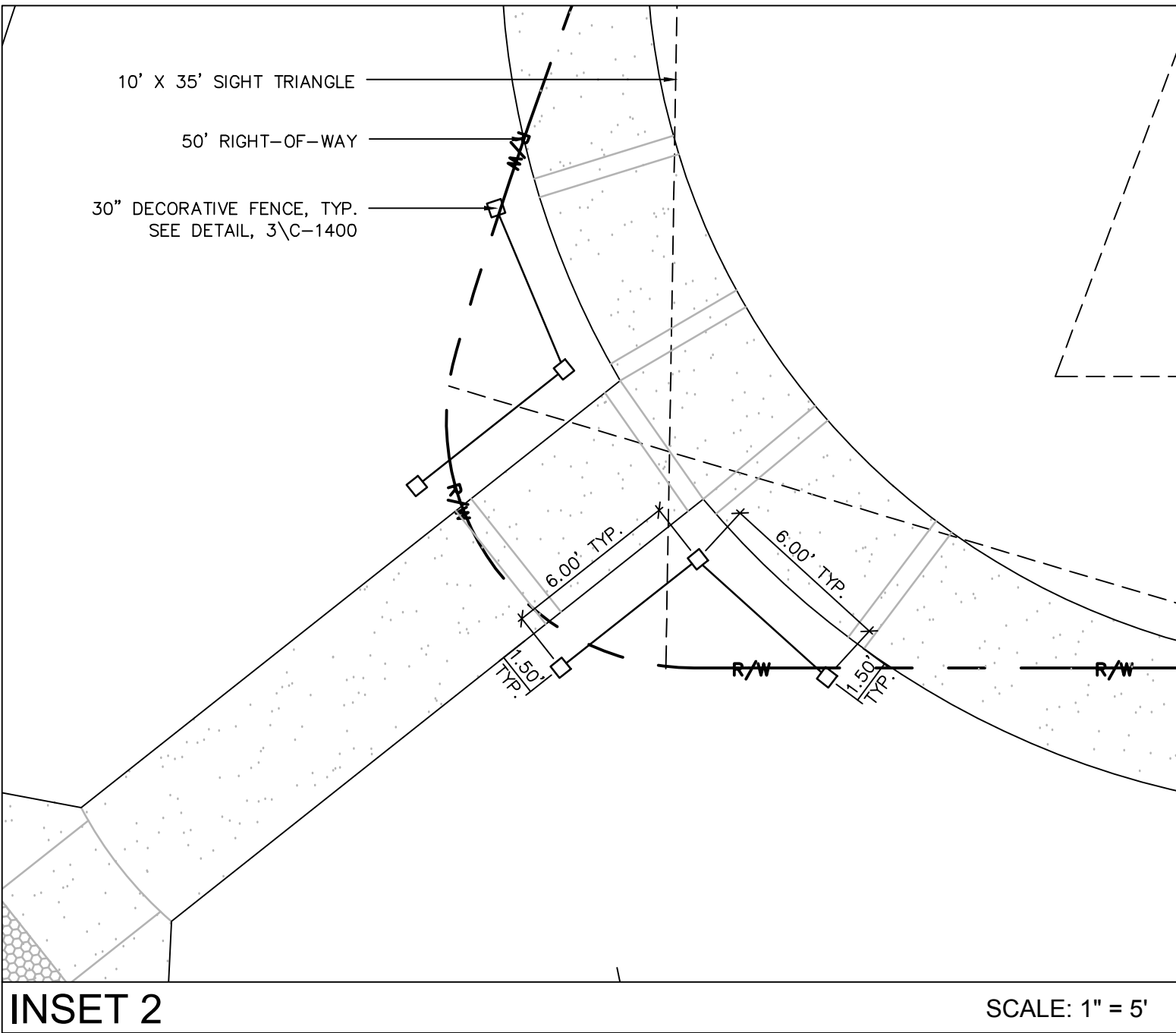
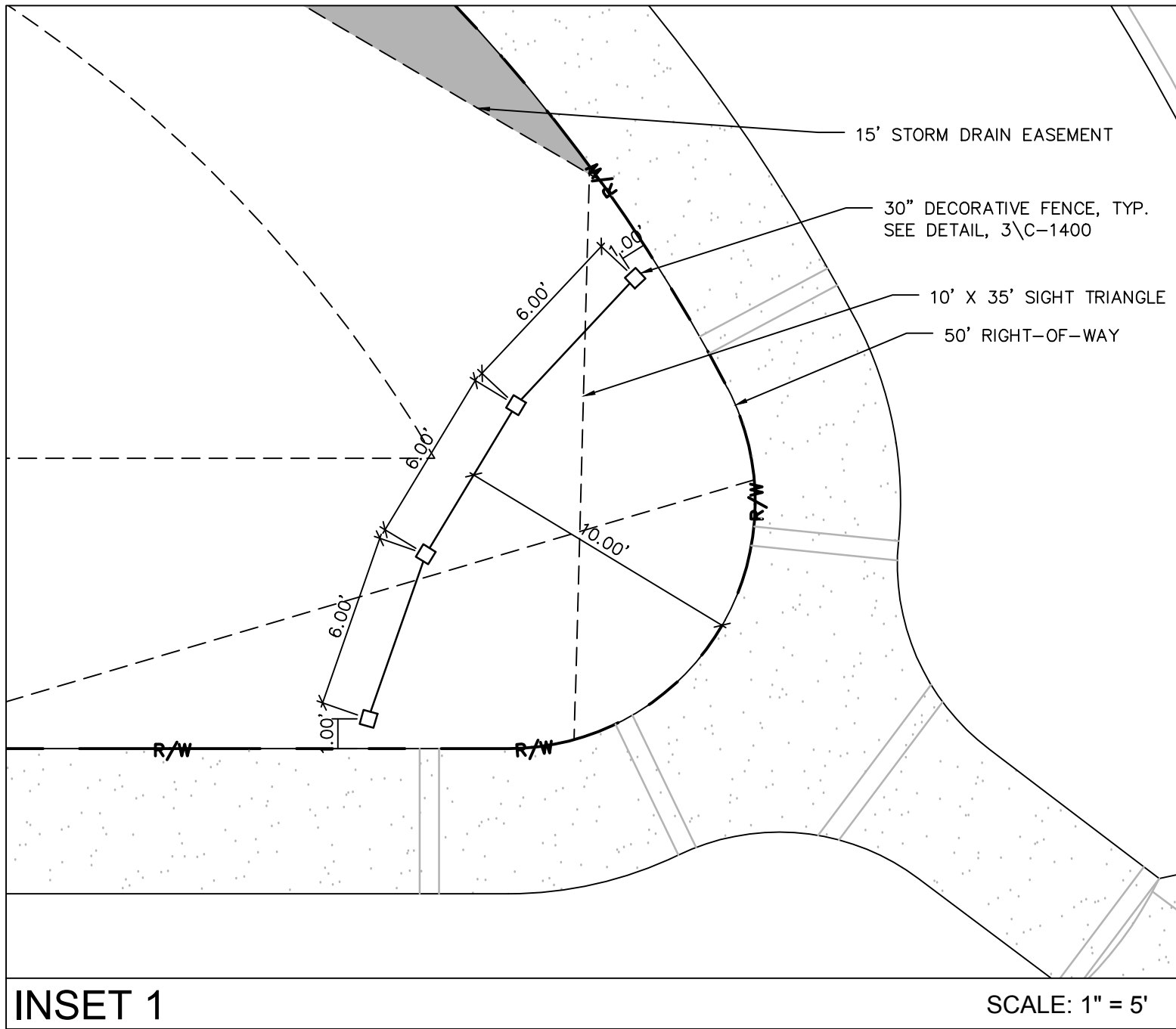
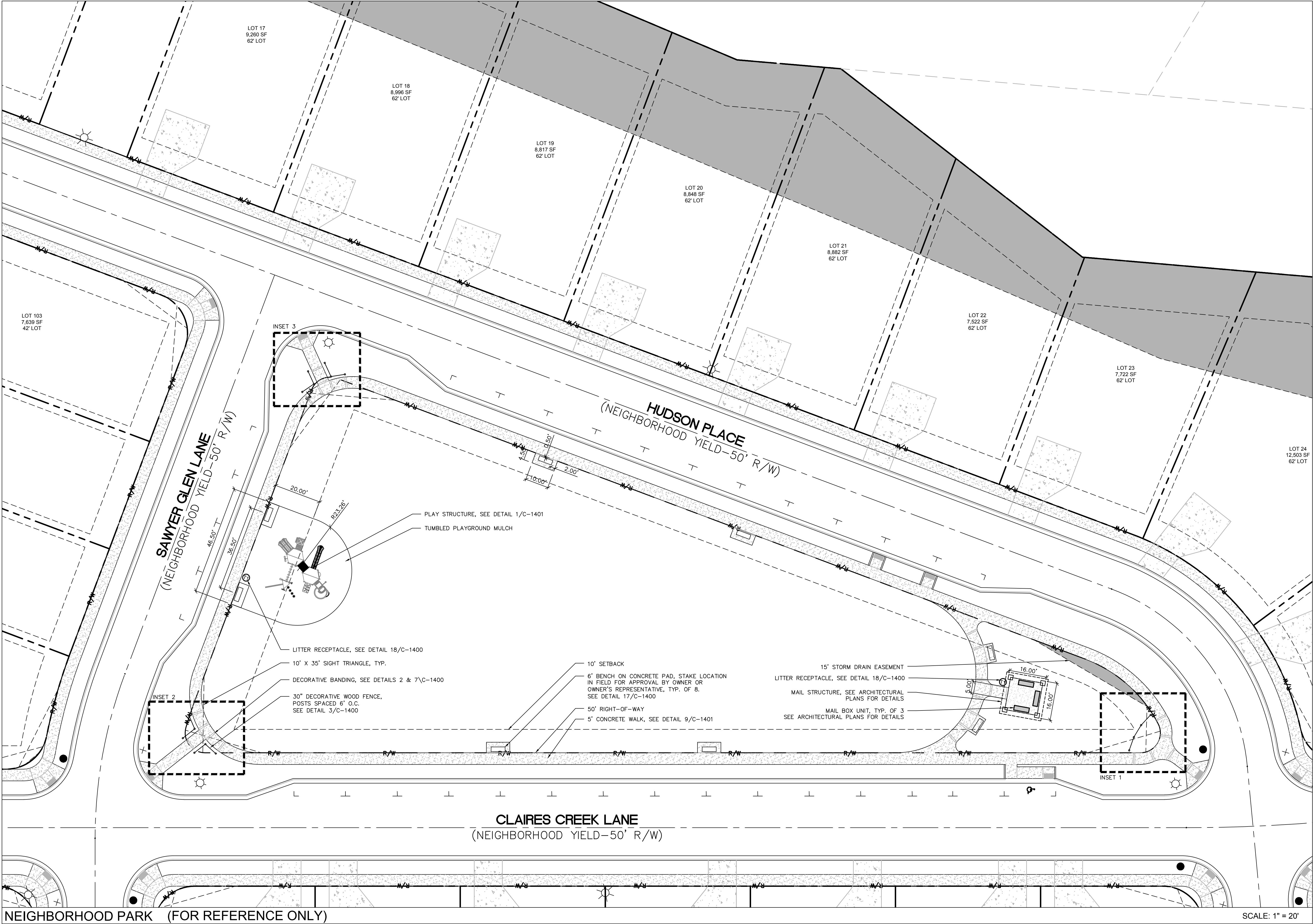

SURVEY DISCLAIMER
TOPOGRAPHIC SURVEY ISSUE DATE: SEPTEMBER 25, 2015.
PROVIDED BY SURVEYOR'S ESP ASSOCIATES, P.A., P.O. BOX 730, 3475 LAKEMOUNT BLVD, CHARLOTTE, NC, 28241, 704.583.4949

SYMBOL	DETAIL
	PROPOSED SIDEWALK 10/C-801
	PROPOSED STANDARD ACCESSIBLE RAMP 17/C-801
	PROPOSED DIRECTIONAL ACCESSIBLE RAMP 19/C-801
	PROPOSED DOUBLE DIRECTIONAL ACCESSIBLE RAMP 19/C-801
	HEAVY DUTY CONCRETE 2/C-801
	PROPOSED STREET SIGN 3,4/C-802
	PROPOSED STOP SIGN R1-1
	PROPOSED 1' CONCRETE RIBBON CURB 20/C-805
	PROPOSED 2'-0" CURB & GUTTER 9/C-801
	PROPOSED LITTER RECEPTACLE 18/C-1400
	PROPOSED STREET LIGHT -/-

NOTE:
ALL DIMENSIONS ARE APPROXIMATE
AND SUBJECT TO VARIATION
THROUGHOUT THIS DECISION
PROCESS



Shaping the Environment
Realizing the Possibilities

Land Planning
+
Landscape Architecture
Civil Engineering
+
Urban Design

200 South Tryon Street, Suite 1400
Charlotte, North Carolina 28202
p+ 704.376.1555 f+ 704.376.7851
url+ www.colejeneststone.com

Lennar Carolinas, LLC

**11230 CARMEL COMMONS BLVD
CHARLOTTE, NC 28226**

WestBranch Amenity

**ROBERT WALKER DRIVE
DAVIDSON, NC 28036**

DIMENSION CONTROL PLAN - NEIGHBORHOOD PARK

Project No.

4418

Issued

01/17/18

Revised



12/08/17

SCALE: 1" = 20'

0 10' 20' 40'

C-1103

- CONTRACTOR IS FULLY RESPONSIBLE FOR CONTACTING APPROPRIATE PARTIES AND ASSURING THAT EXISTING UTILITIES ARE LOCATED PRIOR TO CONSTRUCTION.
- CONTRACTOR IS RESPONSIBLE FOR PLACING BARRICADES USING FLAG MEN, ETC. AS NECESSARY TO INSURE SAFETY TO THE PUBLIC.
- ALL PAVEMENT CUTS, CONCRETE OR ASPHALT, ARE TO BE REPLACED ACCORDING TO STANDARDS OF THE NORTH CAROLINA DEPARTMENT OF TRANSPORTATION AND CHARLOTTE-MECKLENBURG UTILITIES SPECIFICATIONS.
- SHORING WILL BE ACCORDING TO OSHA TRENCHING STANDARDS PART 1926 SUBPART P, OR AS AMENDED.

The drawings, the project manual and the design shown thereon are instruments of ColeJenest & Stone, P.A. The reproduction or unauthorized use of the documents without consent of ColeJenest & Stone, P.A. is prohibited.

ColeJenest & Stone, P.A. 2016 ©

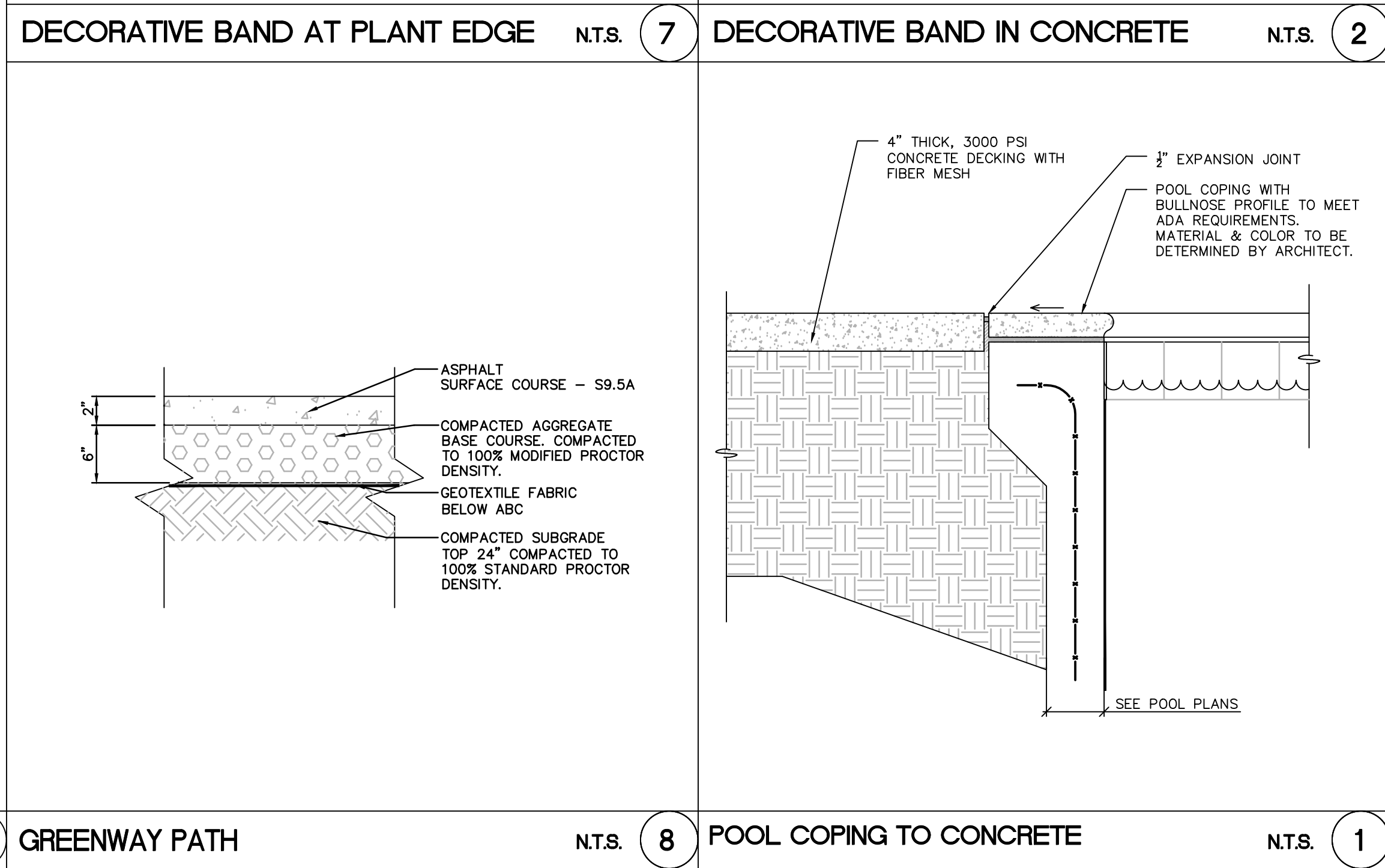
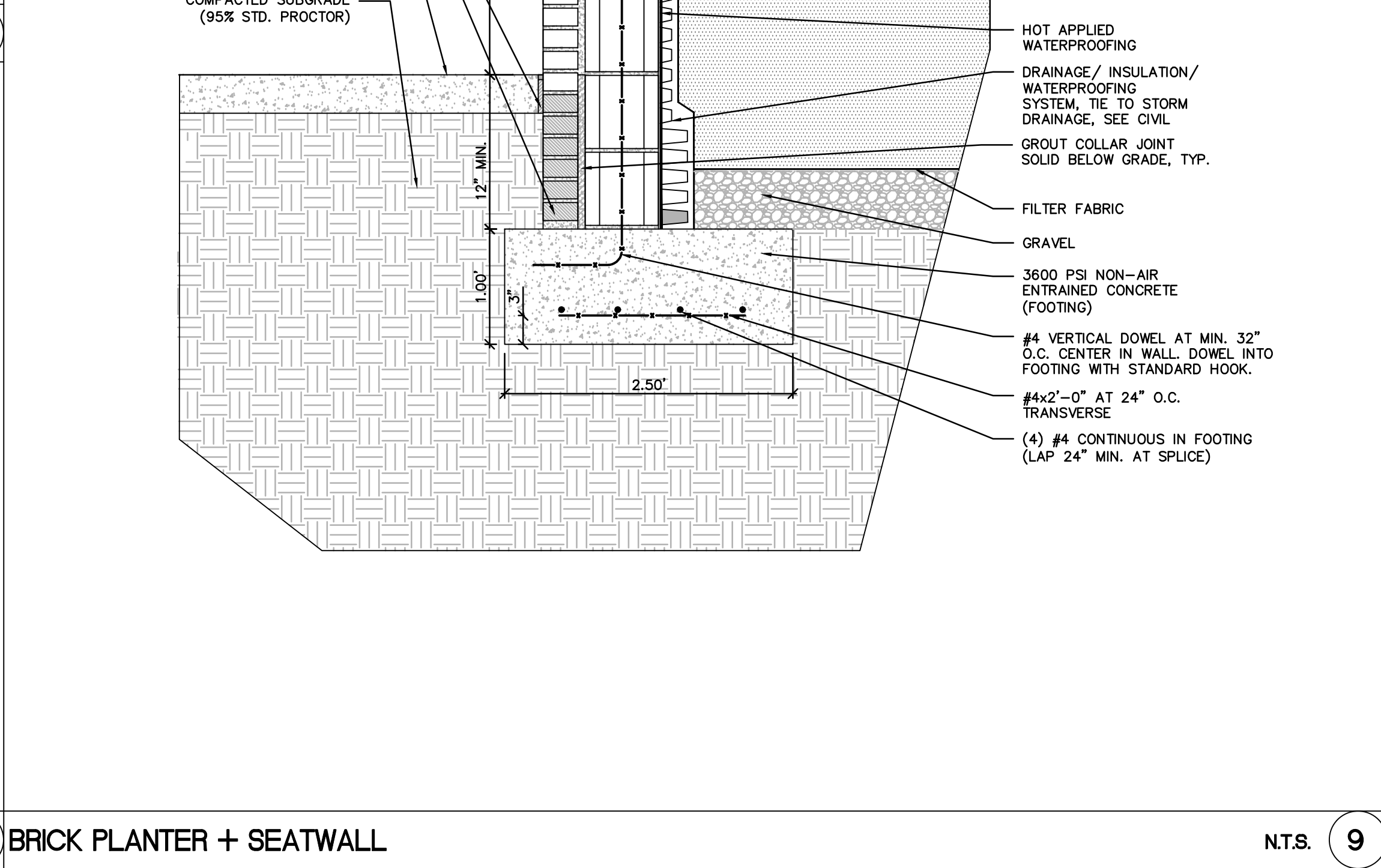
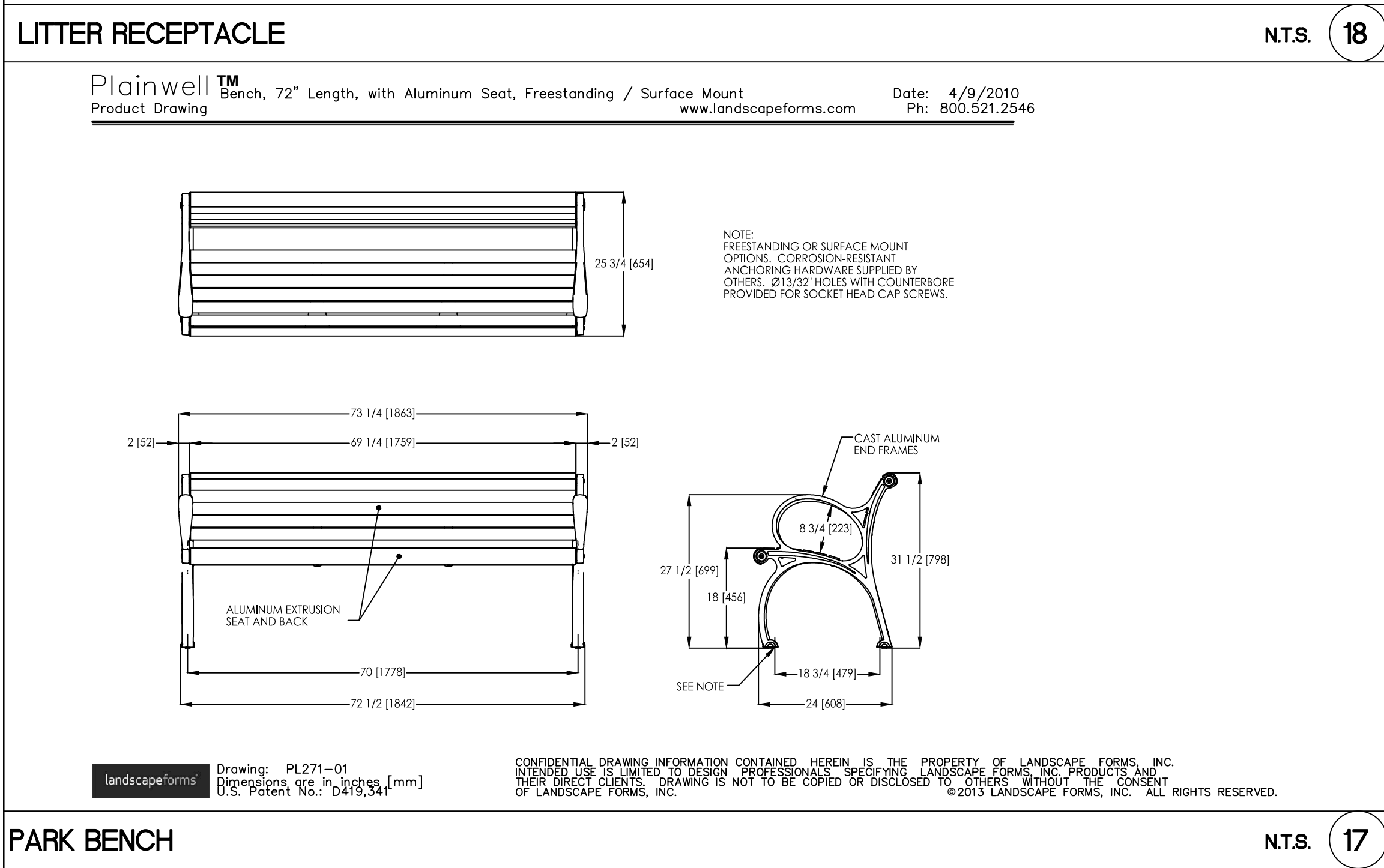
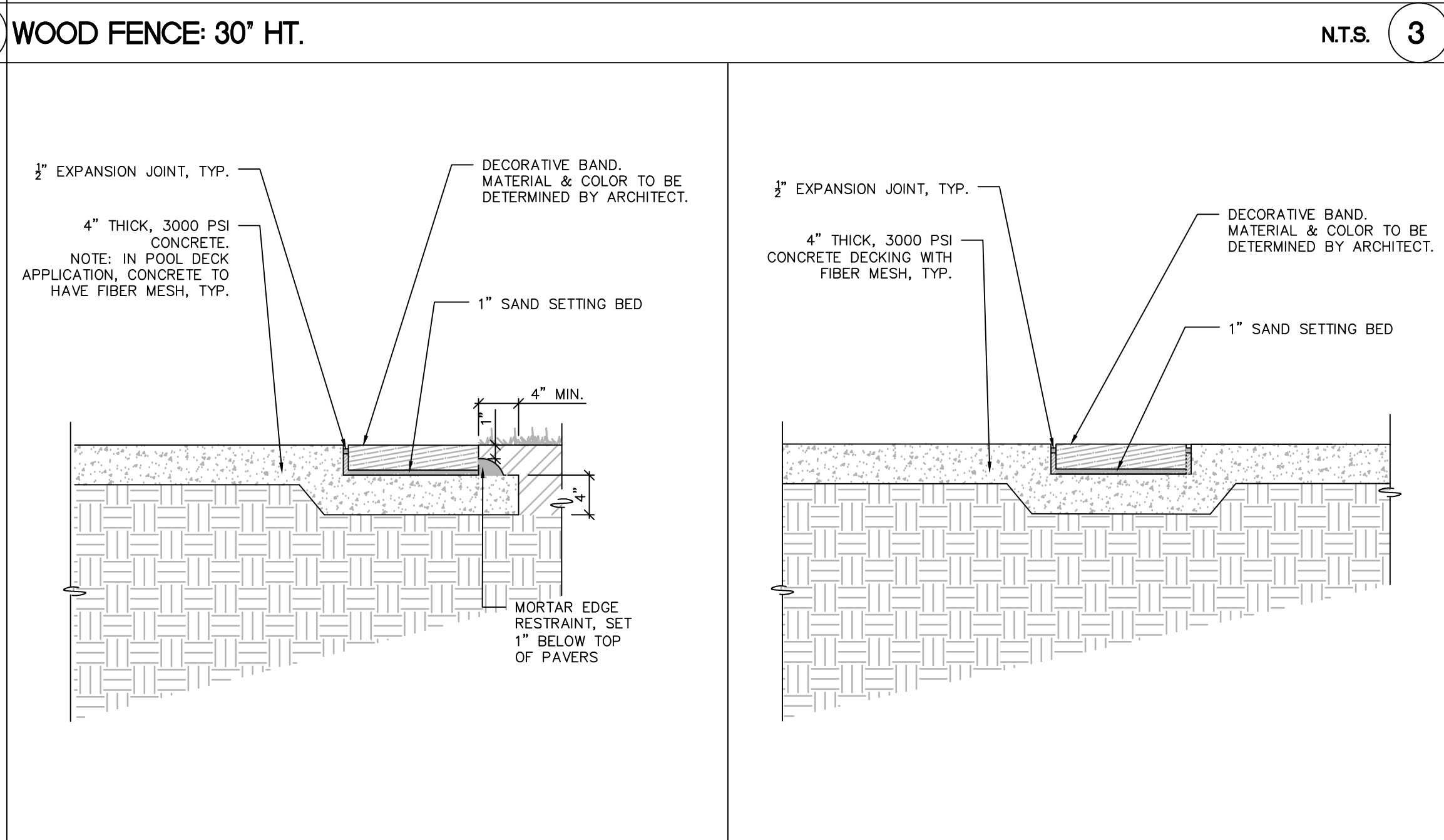
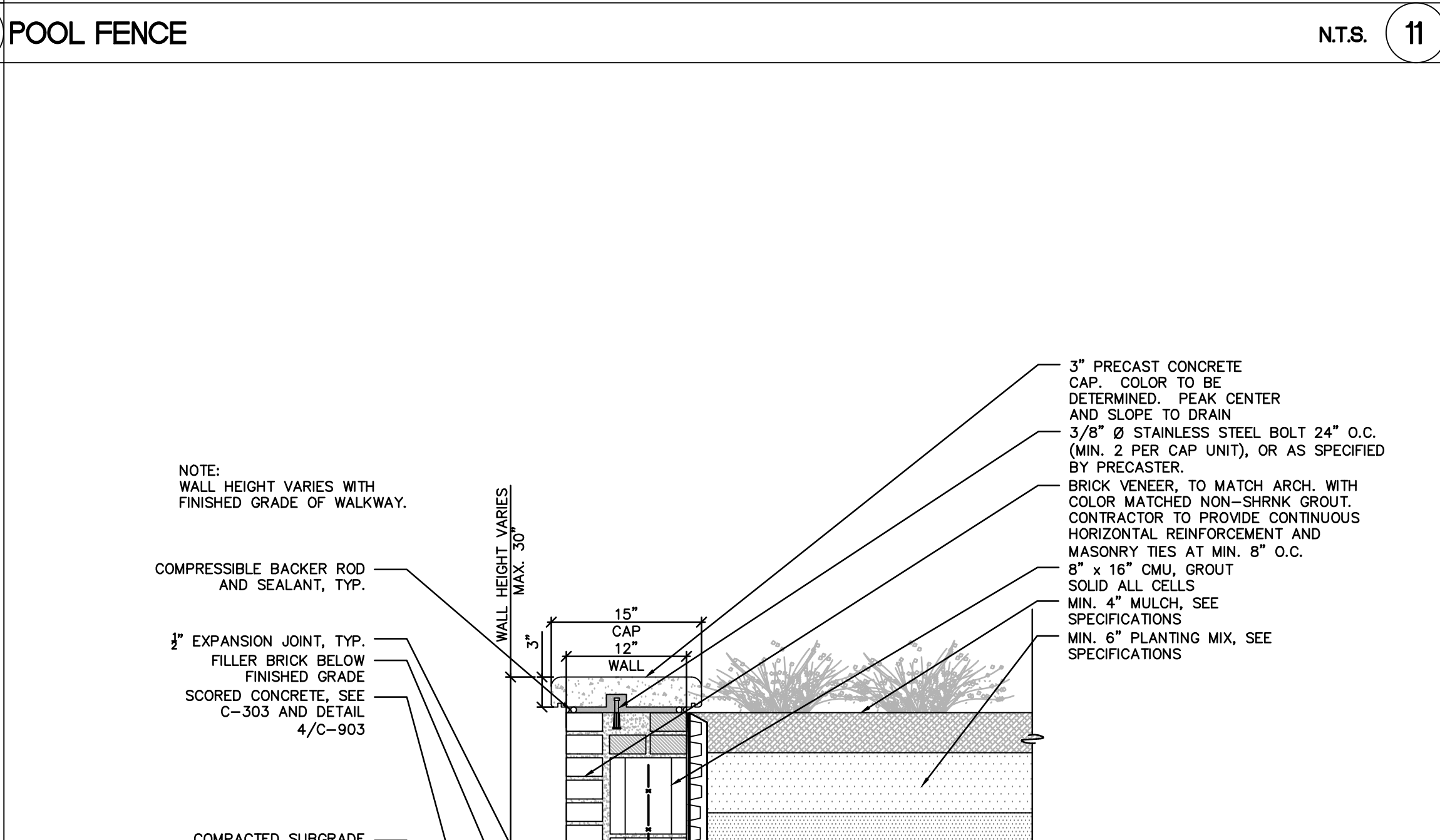
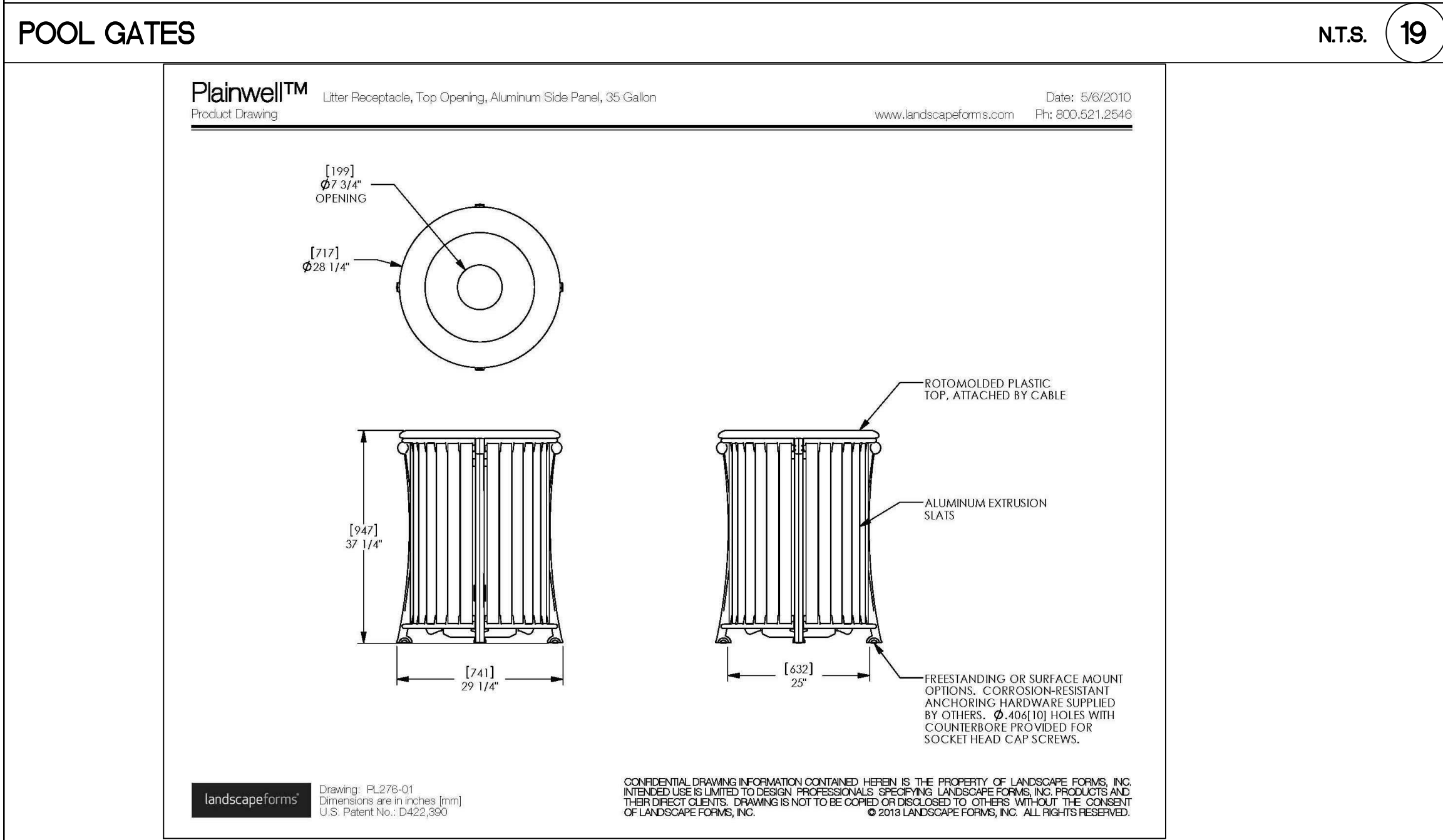
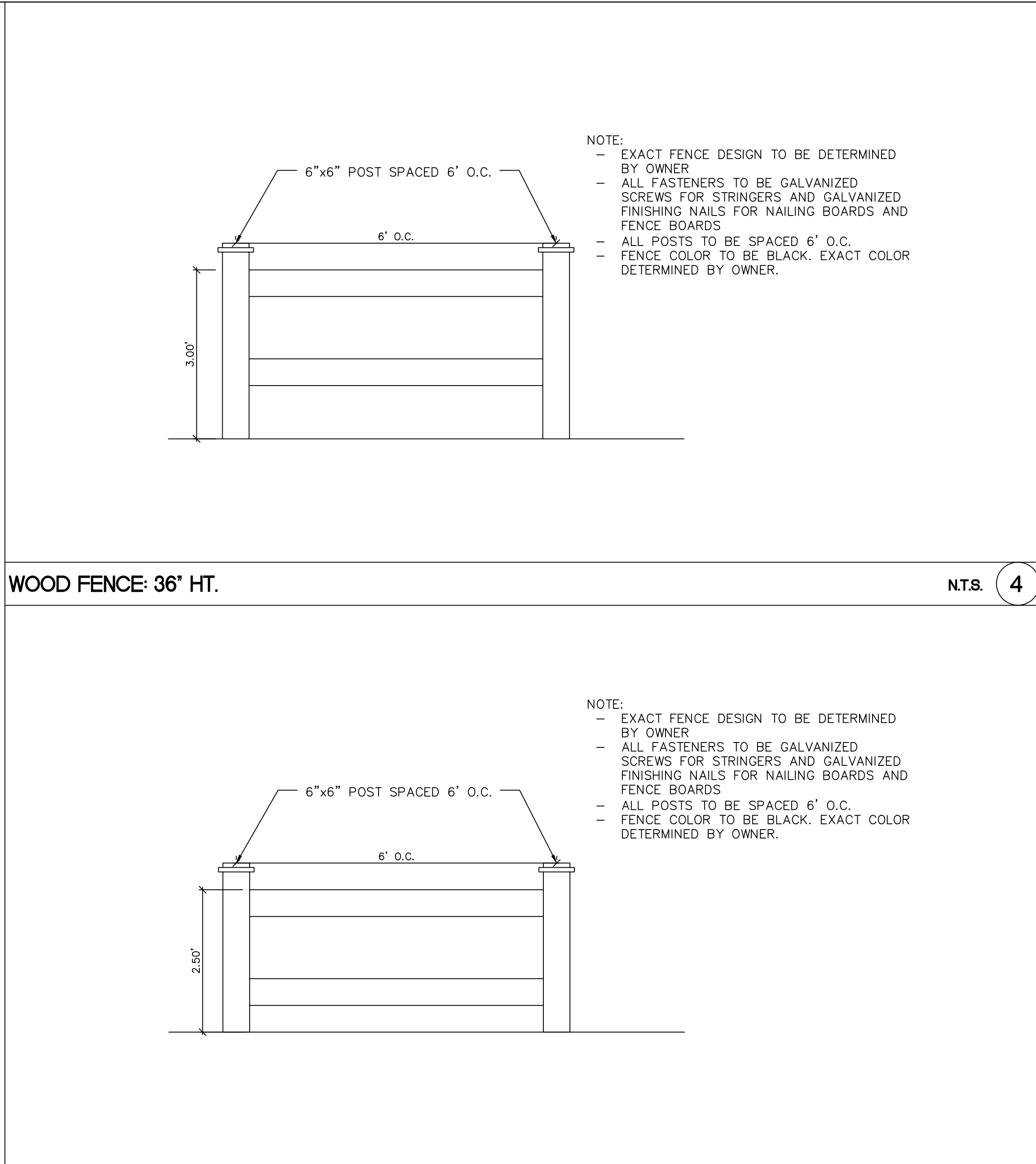
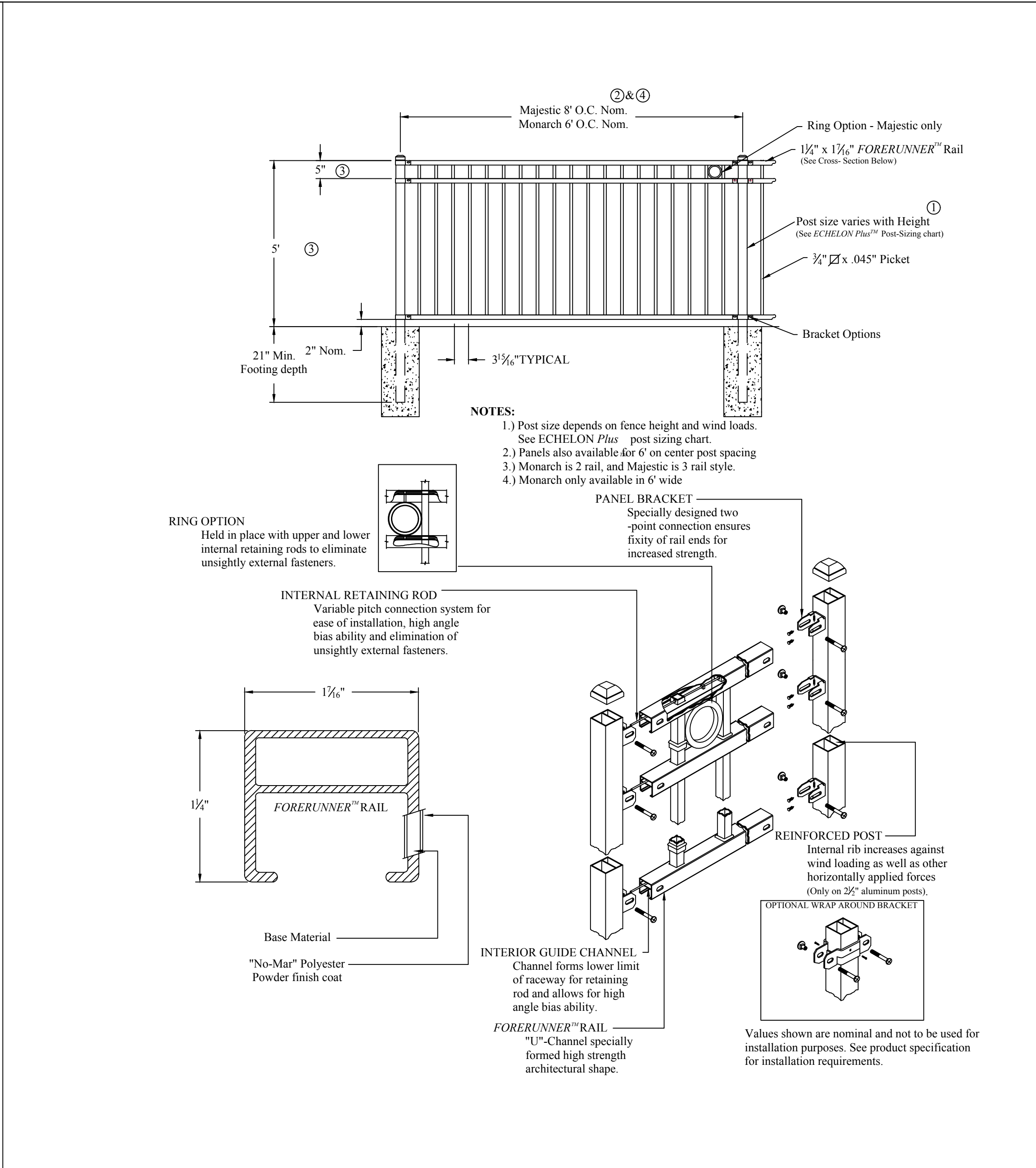
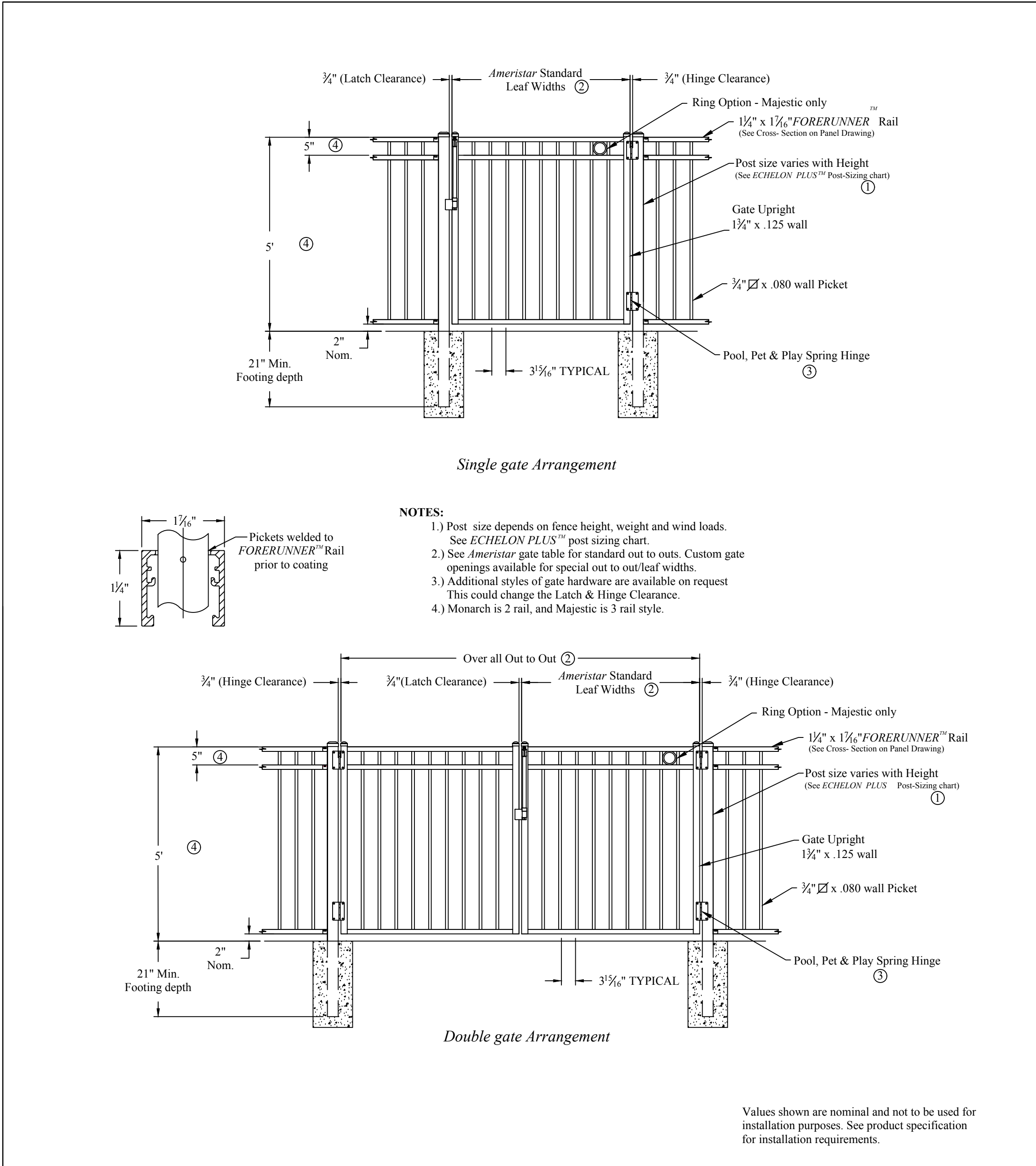

ColeJenest & Stone

Shaping the Environment
Realizing the Possibilities

Land Planning
+
Landscape Architecture
Civil Engineering
+
Urban Design

200 South Tryon Street, Suite 1400
Charlotte, North Carolina 28202

p+ 704.376.1555 f+ 704.376.7851
url+ www.colejeneststone.com

Lennar Carolinas, LLC

11230 CARMEL COMMONS BLVD
CHARLOTTE, NC 28226

**WestBranch
Amenity**

ROBERT WALKER DRIVE
DAVIDSON, NC 28036

DETAILS

Project No.
4418

Issued
01/17/18

Revised

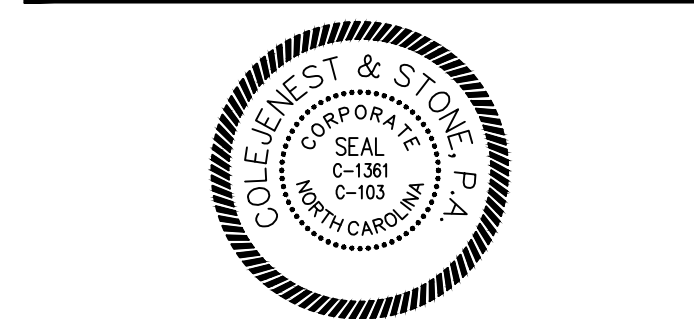

C-1400

The drawings, the project manual and the design shown thereon are instruments of ColeJenest & Stone, P.A. The reproduction or unauthorized use of the documents without consent of ColeJenest & Stone, P.A. is prohibited.

ColeJenest & Stone, P.A. 2017 ©

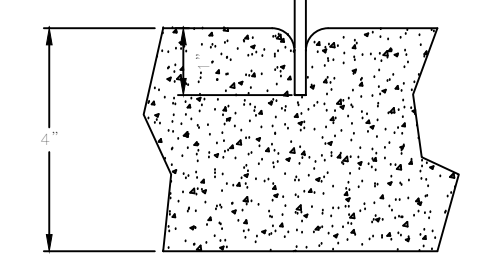
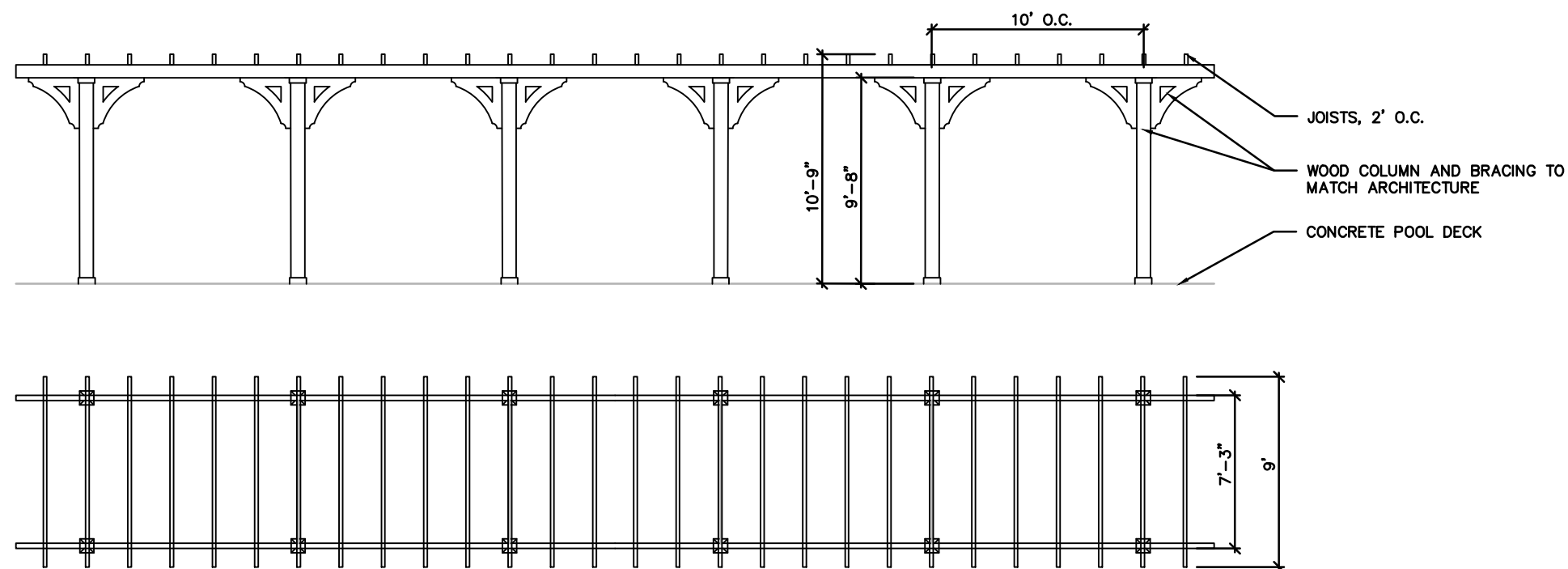

GROOVE JOINT IN SIDEWALK

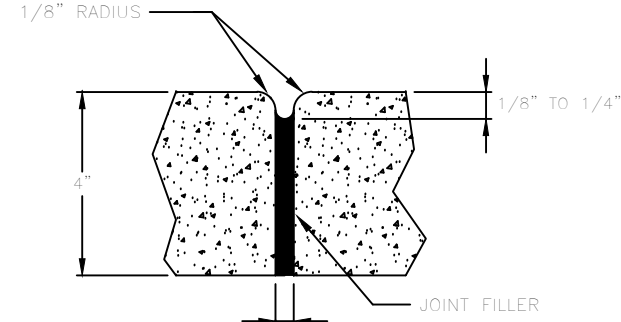

TRANSVERSE EXPANSION JOINT IN SIDEWALK

APPROVED DATE: 02/2007

MECKLENBURG COUNTY
LAND DEVELOPMENT
STANDARDS



CONCRETE SIDEWALKS

10.22

GENERAL NOTES:

1. A GROOVE JOINT 1" DEEP WITH 1/8" RADI SHALL BE REQUIRED IN THE CONCRETE SIDEWALK AT 5' INTERVALS. THE 1/2" EXPANSION JOINT WILL BE REQUIRED AT 45' INTERVALS NOT TO EXCEED 50' AND MATCHING EXPANSION/CONSTRUCTION JOINT IN ADJACENT CURB. A SEALED 1/2" EXPANSION JOINT WILL BE REQUIRED WHERE THE SIDEWALK JOINS ANY RIGID STRUCTURE.
2. SIDEWALK AT DRIVEWAY ENTRANCES TO BE 8" THICK.
3. WIDTH OF SIDEWALK ON THOROUGHFARE STREETS SHALL BE A MINIMUM OF 5'.
4. WIDTH OF SIDEWALKS ON NON-THOROUGHFARE STREETS SHALL BE A MINIMUM OF 3'.
5. SIDEWALK TO BE POURED TO END OF RADIUS AT INTERSECTING STREETS.
6. CONCRETE COMPRESSIVE STRENGTH SHALL BE 3000 PSI. IN 28 DAYS.
7. ZONING CONDITIONS MAY REQUIRE ADDITIONAL WITH SIDEWALKS WHICH SHALL SUPERSEDE THESE STANDARD DIMENSIONS SHOWN.

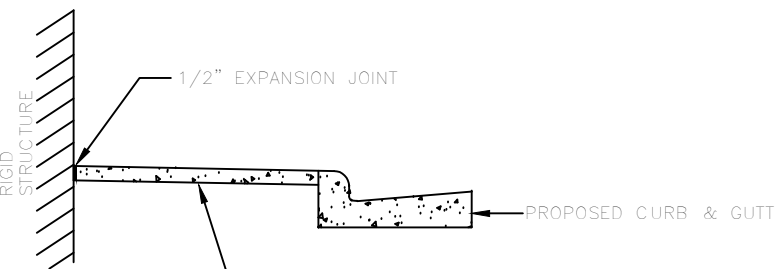

DETAILS SHOWING EXPANSION JOINTS

FOR CONCRETE SIDEWALK

NOT TO SCALE

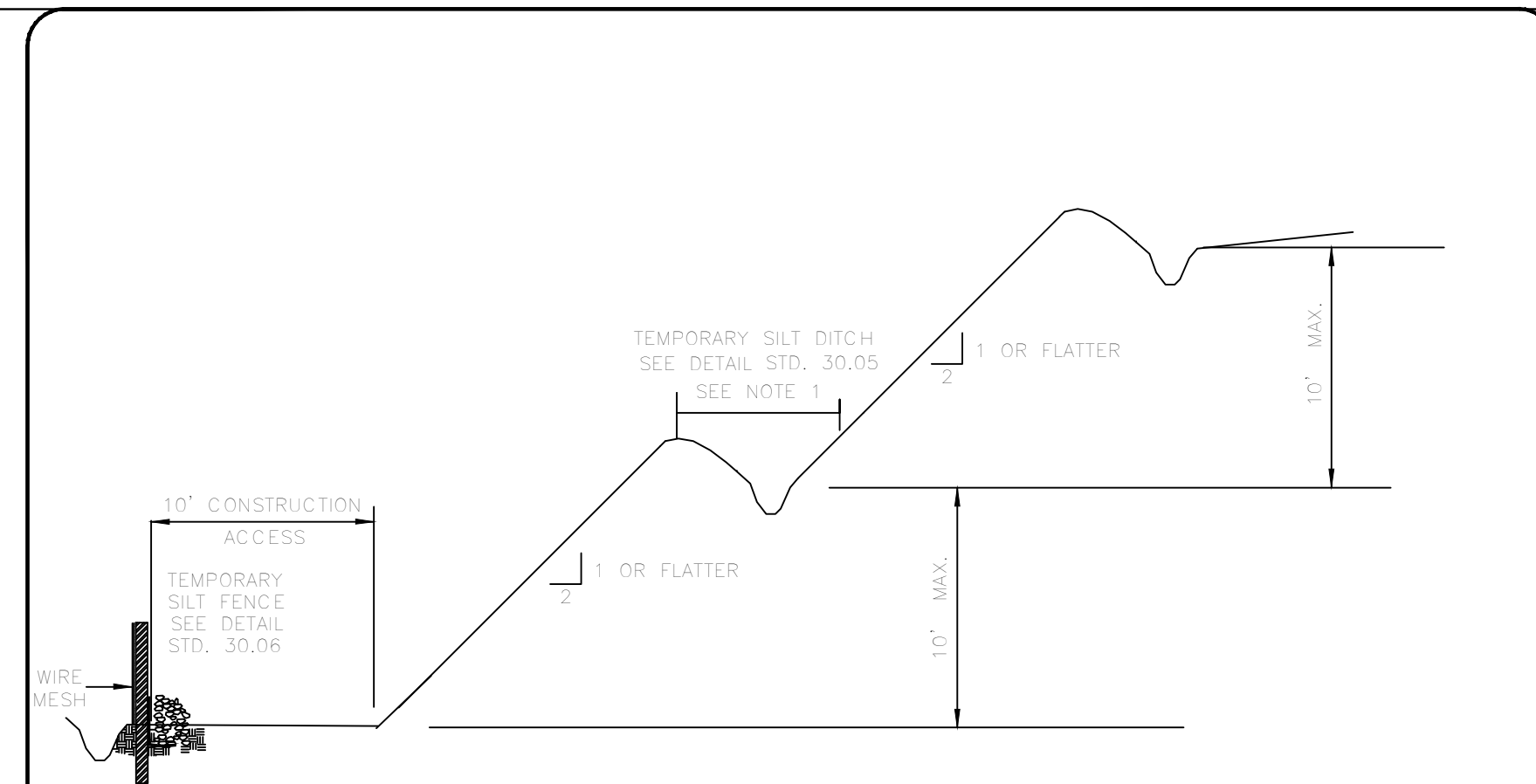

NOTES:

1. DIVERSION DITCH SHOULD FLOW INTO SEDIMENT BASIN, ROCK CHECK DAM, OR SLOPE DRAIN.
2. REFER TO NCSDPDM TABLE 6.02A FOR SPACING OF SLOPE BREAKS.

APPROVED DATE: 02/2007

MECKLENBURG COUNTY
LAND DEVELOPMENT
STANDARDS



SLOPE STABILITY

30.16

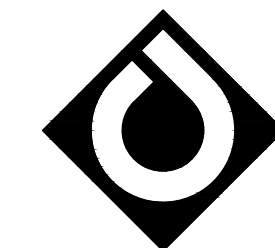

ColeJenest
& Stone

Shaping the Environment
Realizing the Possibilities

Land Planning
+
Landscape Architecture
Civil Engineering
+
Urban Design

200 South Tryon Street, Suite 1400
Charlotte, North Carolina 28202

p+ 704.376.1555 f+ 704.376.7851
url+ www.colejeneststone.com

Lennar Carolinas, LLC

11230 CARMEL COMMONS BLVD
CHARLOTTE, NC 28226

WestBranch
Amenity

ROBERT WALKER DRIVE
DAVIDSON, NC 28036

DETAILS

PERGOLA PLAN + SECTION

NTS.

13

CONCRETE SIDEWALKS

MCLDS 10.22

NTS.

9

SLOPE STABILITY

NTS.

5

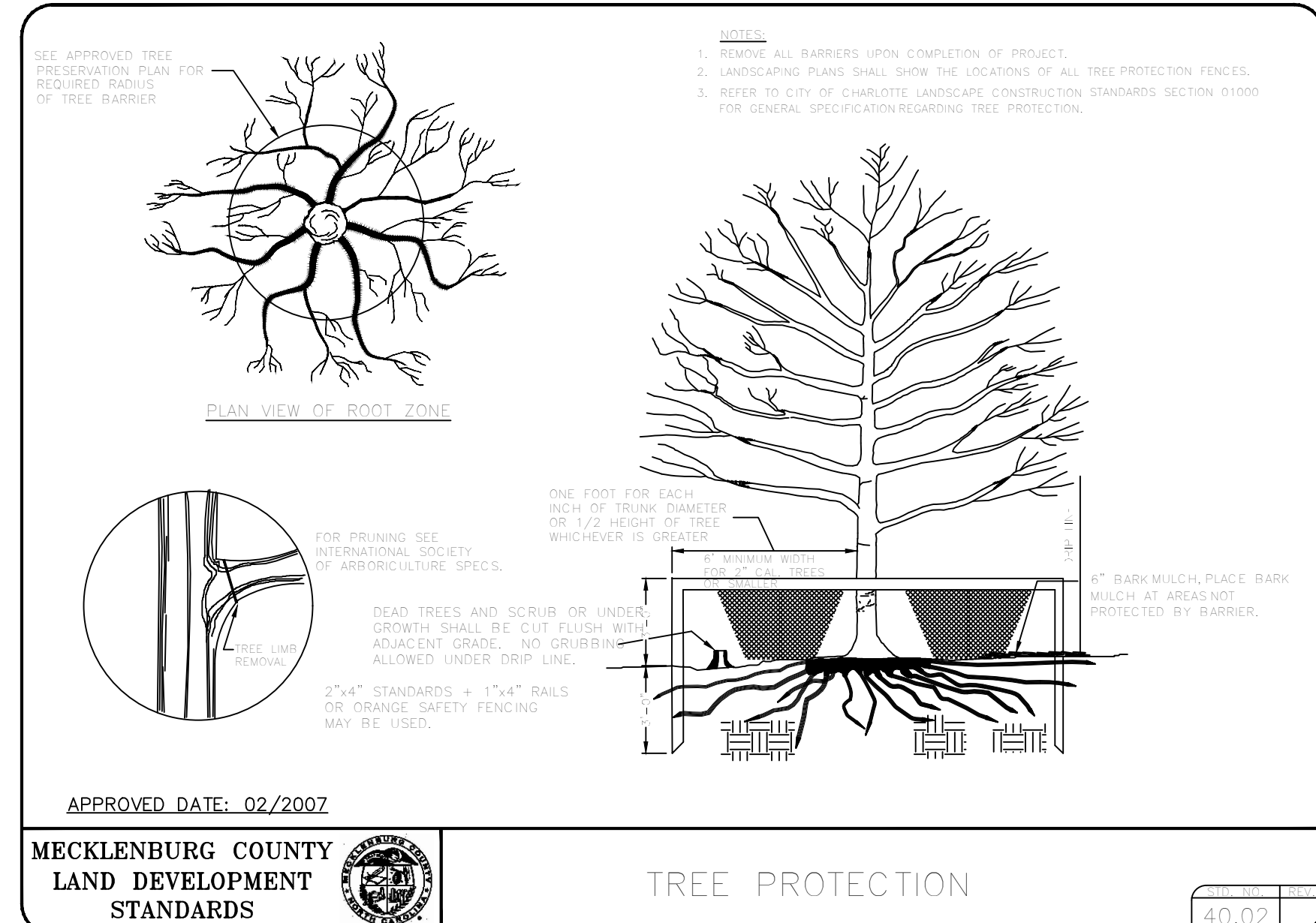

APPROVED DATE: 02/2007

MECKLENBURG COUNTY
LAND DEVELOPMENT
STANDARDS

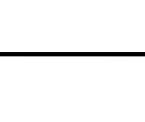

TREE PROTECTION

40.02

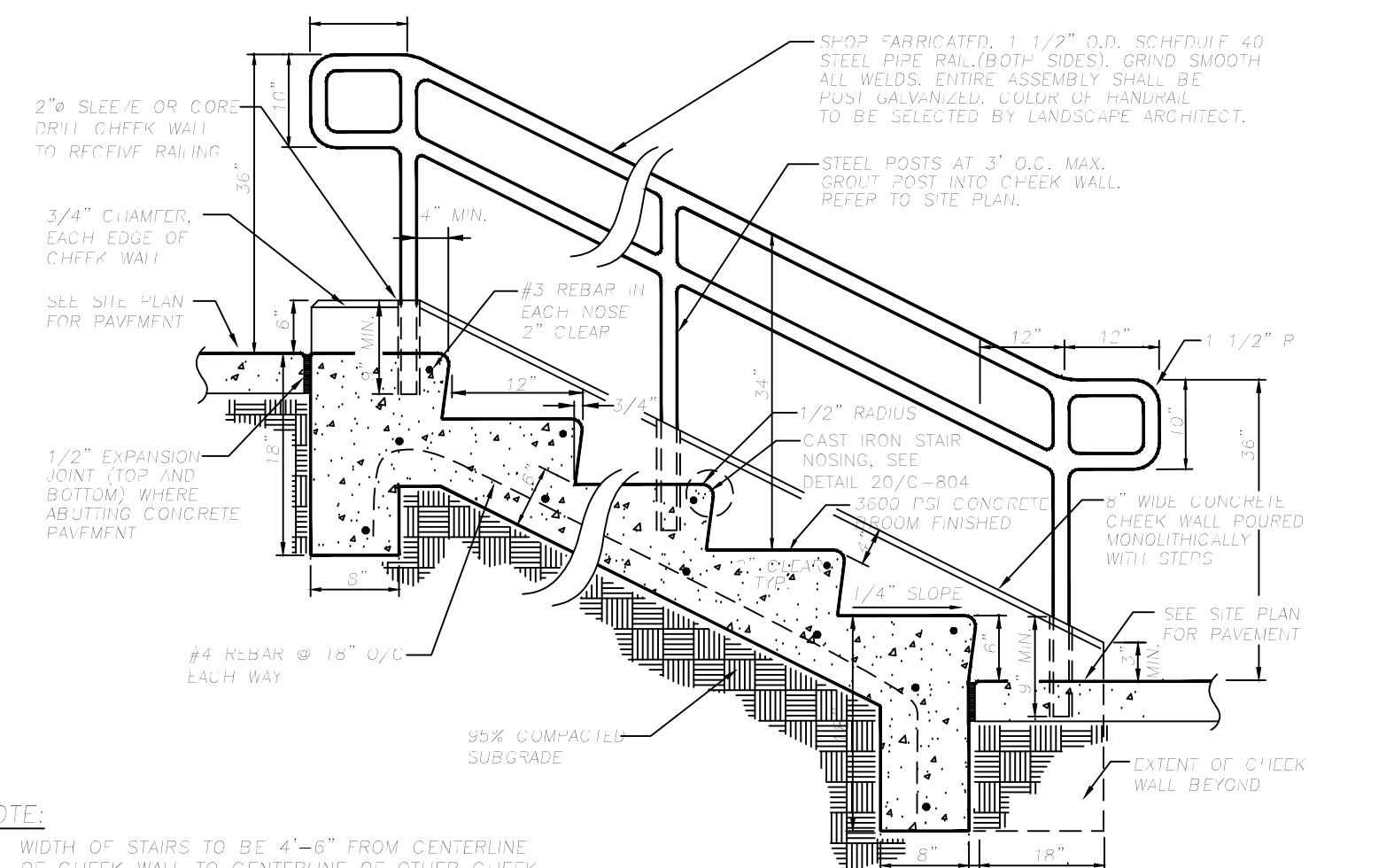

- NOTE:
1. WIDTH OF STAIRS TO BE 4'-0" FROM CENTERLINE OF CHEEK WALL TO CENTERLINE OF OTHER CHEEK WALL UNLESS OTHERWISE INDICATED ON PLAN.
 2. SEE GRADING PLAN FOR NUMBER OF RISES.
 3. EXPANSION JOINTS SHALL BE PRE-MOLDED BITUMINOUS IMPREGATED FIBER-BOARDS.

APPROVED DATE: 02/2007

MECKLENBURG COUNTY
LAND DEVELOPMENT
STANDARDS



SEEDING SCHEDULE
(SEASONAL)

30.17B

TEMPORARY SEEDING FOR WARM AND COOL SEASON

	EARLY SUMMER SEASON	STEEP SLOPES
SEEDING MIXTURE	40 lbs/acre of German millet 80 lbs/acre of tall fescue	120 lbs/acre Rye (grain) 80 lbs/acre tall fescue
SEEDING DATES	May 1 - August 15 Referfertilize if growth is not fully adequate. Apply 4000 lbs/acre straw or equivalent hydrossedding.	October 25 - December 30 Between December 30 - February 15, add 50 lbs/acre of annual Kobe lespedeza. Apply 4000 lbs/acre straw or equivalent hydrossedding.
SEEDING AMENDMENTS	Apply lime and fertilizer per soil tests, or 2000 lbs/acre limestone and 750 lbs/acre 10-10-10 fertilizer.	Apply lime and fertilizer per soil tests, or 2000 lbs/acre limestone and 750 lbs/acre 10-10-10 fertilizer.

APPROVED DATE: 02/2007

MECKLENBURG COUNTY
LAND DEVELOPMENT
STANDARDS



SEEDING SCHEDULE
(SEASONAL)

30.17B

TREE PROTECTION

MCLDS 40.02

NTS.

12

CONCRETE STAIRS WITH CHEEK WALL

NTS.

8

NTS.

4

HEAVY DUTY CONCRETE

NTS.

3

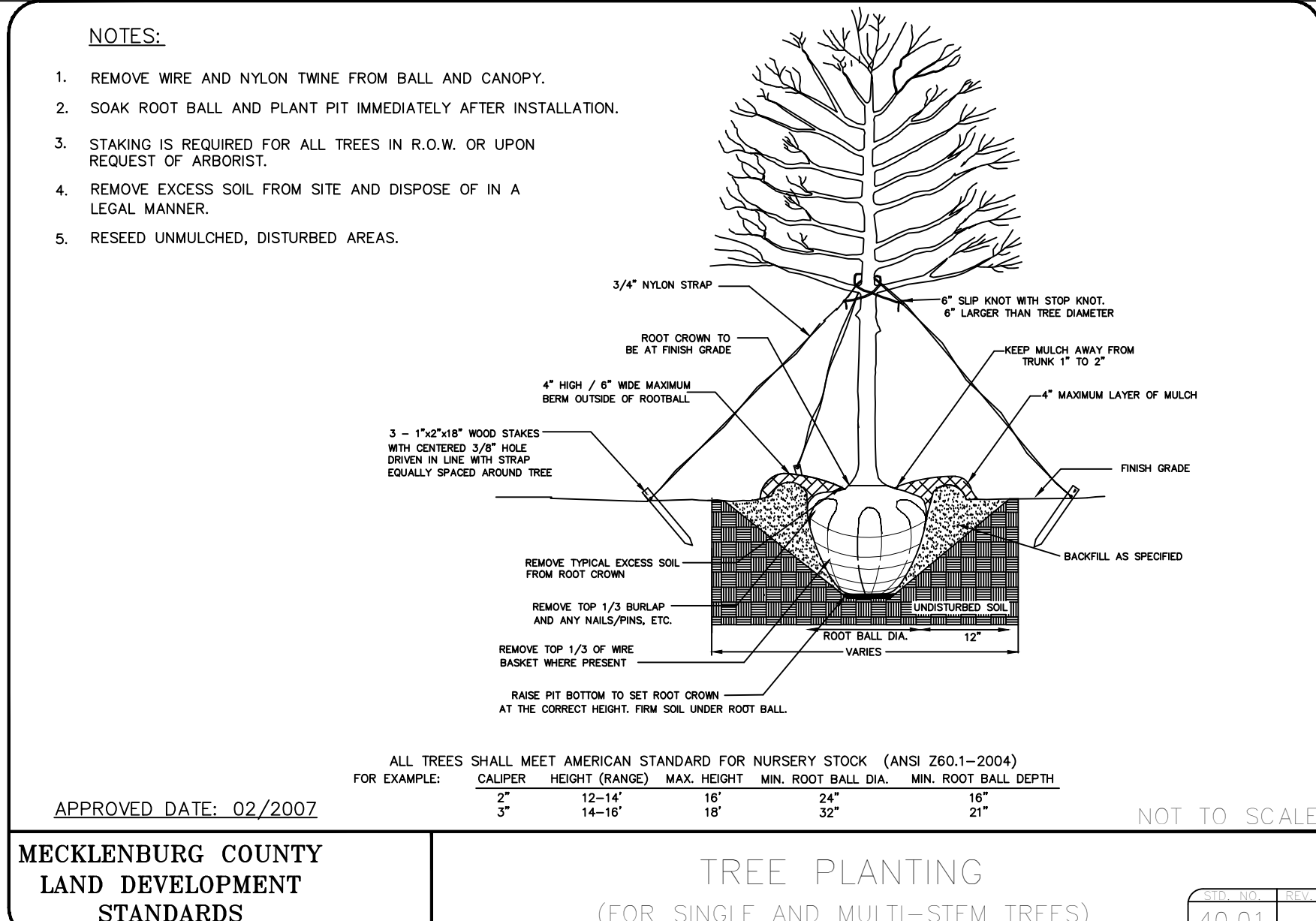

APPROVED DATE: 02/2007

MECKLENBURG COUNTY
LAND DEVELOPMENT
STANDARDS

TREE PLANTING

(FOR SINGLE AND MULTI-STEM TREES)

40.01

TREE PLANTING

MCLDS 40.01

NTS.

11

SEEDING SCHEDULE (SEASONAL)

MCLDS 10.22

NTS.

7

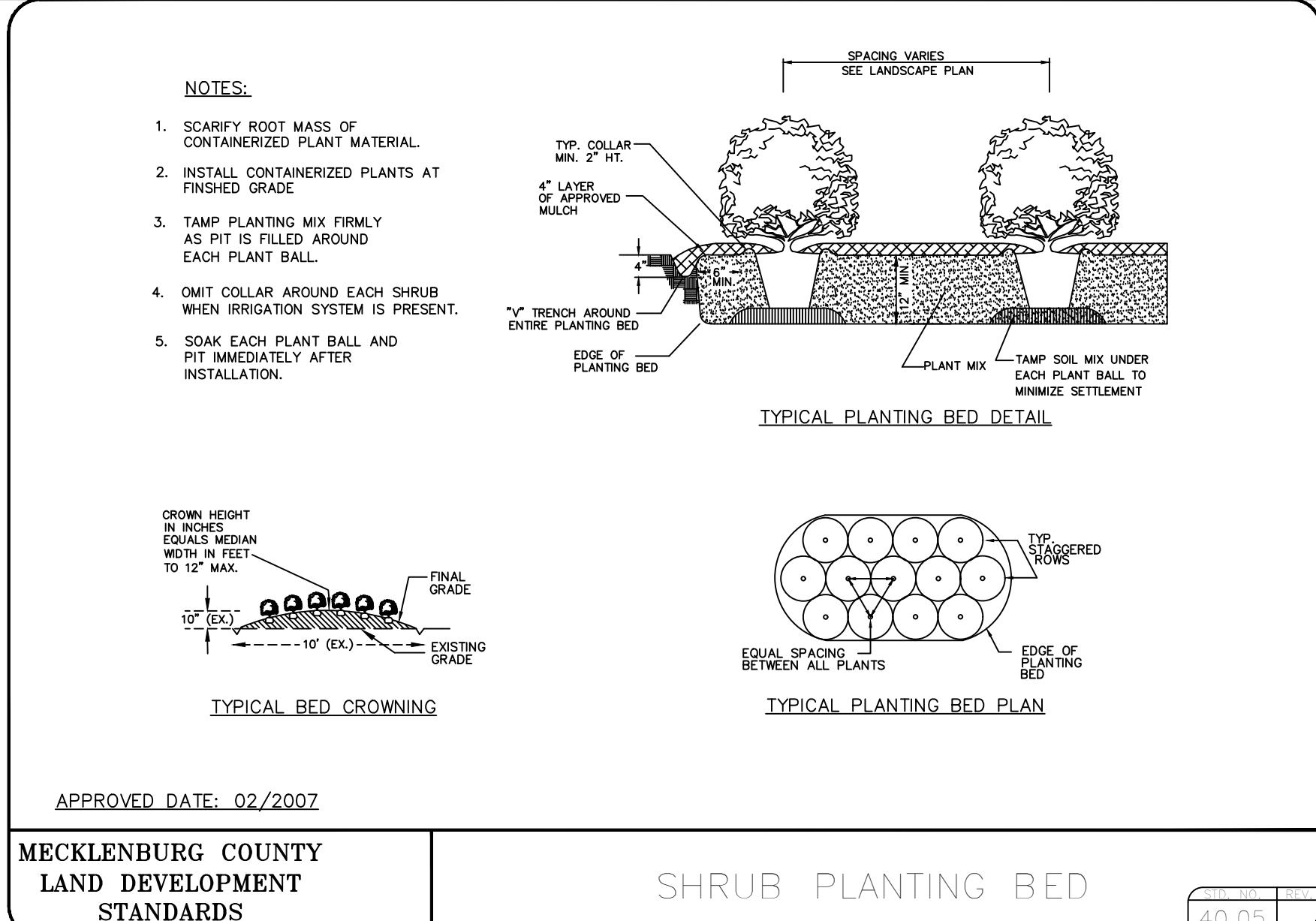

APPROVED DATE: 02/2007

MECKLENBURG COUNTY
LAND DEVELOPMENT
STANDARDS

SHRUB PLANTING BED

40.05

SHRUB PLANTING BED

MCLDS 40.05

NTS.

10

SEEDING SCHEDULE

MCLDS 10.17A

NTS.

6

PLAYGROUND STRUCTURE

NTS.

1

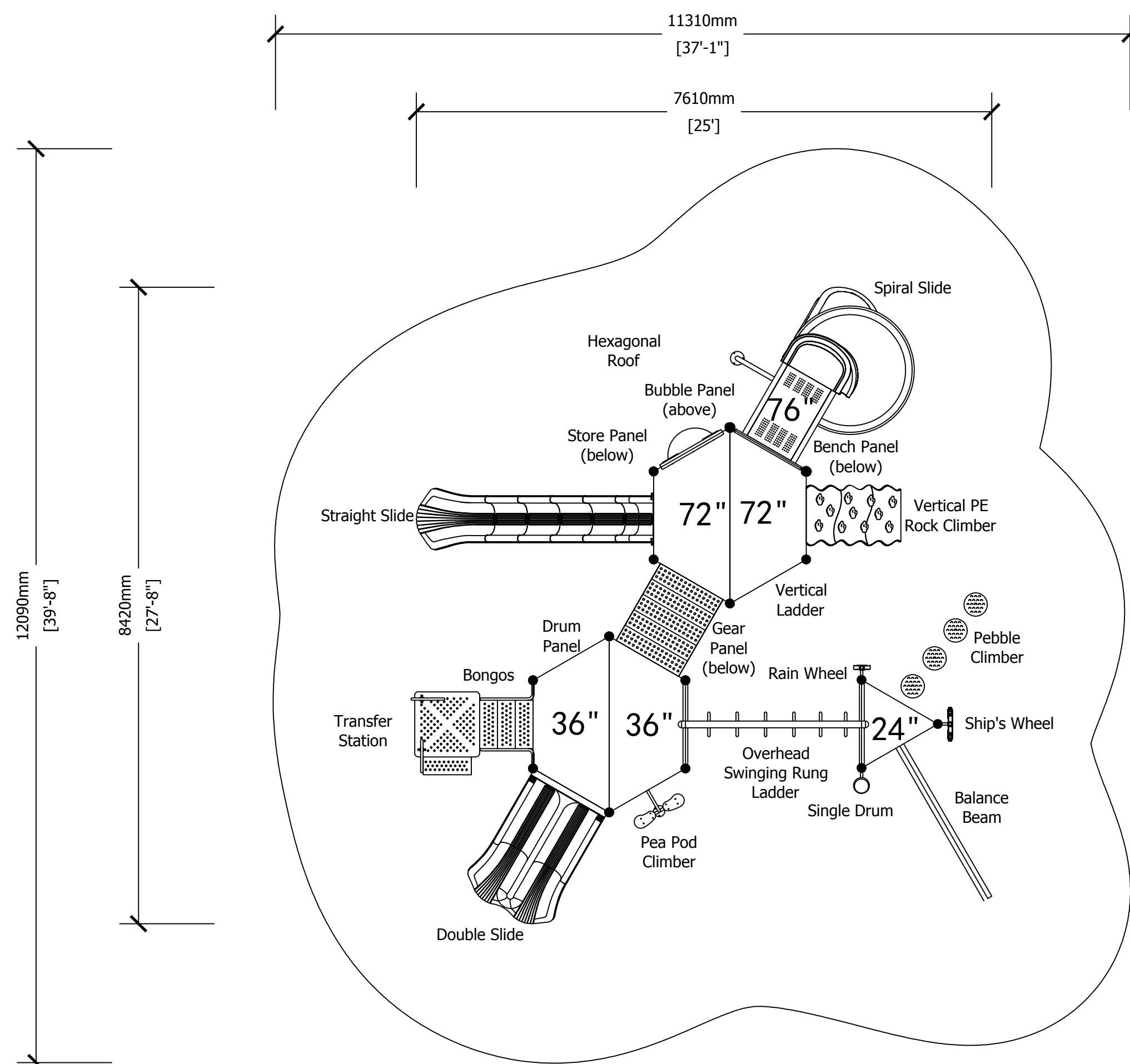

Project No.

4418

Issued

01/17/18

Revised



C-1401

The drawings, the project manual and the design shown thereon are instruments of ColeJenest & Stone, P.A. The reproduction or unauthorized use of the documents without consent of ColeJenest & Stone, P.A. is prohibited.

ColeJenest & Stone, P.A. 2017 ©